

# EAO – Your Expert Partner for Human Machine Interfaces

61-7100.02 - Buzzer

## 61-7100.02 - Buzzer



*Attention: The preview is based on a sample product. This can differ from your current configuration.*

### Mounting

Mounting cut-out  
Design

Ø 22,3 mm  
flush

### Front

Front dimension  
Front shape  
Front cap colour  
Front cap material

Ø 25 mm  
round  
black  
Plastic

### Other Attributes

Weight  
Operating voltage

0,015 kg  
10 ... 26 V DC

### IP-Rating

Front protection

IP65

### Connection Method

Terminal

Plug 2.8 x 0.5 mm

### Function

Buzzer

# EAO – Your Expert Partner for Human Machine Interfaces

61-7100.02 - Buzzer

## Dimensions

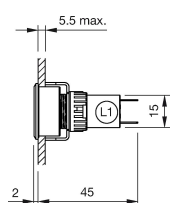

P = Plug-in terminal 2.8 x 0.5 mm

## Mounting cut-outs

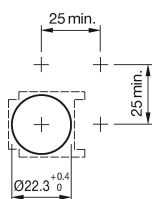

## Wiring diagram

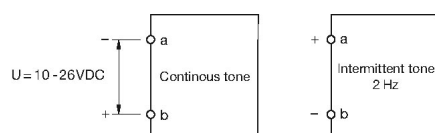

## Additional information

Further information see «Technical data»