

EAO – Your Expert Partner for Human Machine Interfaces

44-800.2 - Lever switch complete

44-800.2 - Lever switch complete



Attention: The preview is based on a sample product. This can differ from your current configuration.

Mounting

Mounting cut-out	Ø 22,3 mm
Design	raised

Front

Front shape	round
Front dimension	Ø 22 mm

Other Attributes

Weight	0,080 kg
--------	----------

Operating-/Indication part

Lever colour	black
Lever material	Plastic

IP-Rating

Front protection	IP65
------------------	------

Connection Method

Terminal	Solder 2.8 x 0.5 mm
----------	---------------------

Actuator

Switching action	Momentary
------------------	-----------

Switching element

Switching voltage	250 V AC
Switching current	5 A
Contacts	2 NC + 2 NO
Switching system	Snap-action switching element
Contact material	

Function

Lever switch	
--------------	--

EAO – Your Expert Partner for Human Machine Interfaces

44-800.2 - Lever switch complete

Dimensions

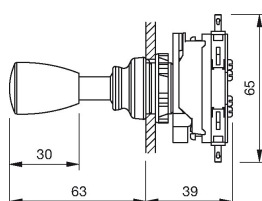

Mounting cut-outs

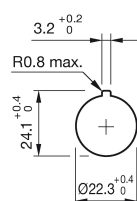

Wiring diagram

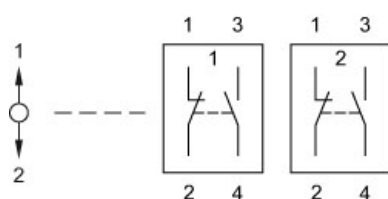

Component layout

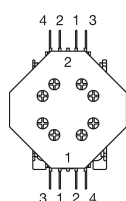

Additional information

2 positions (L-R)

With flat receptacle, VDE 0630 (SEV) specify use of insulating sleeve Part No. 280-0010-00

Legend

Contacts: NC = Normally closed, NO = Normally open

Switching action: B = Momentary