

EAO – Your Expert Partner for Human Machine Interfaces

61-2101.0/D - Keylock switch actuator 2 positions square

61-2101.0/D - Keylock switch actuator 2 positions square

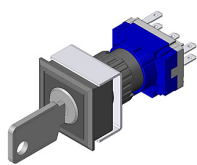

Attention: The preview is based on a sample product. This can differ from your current configuration.

Mounting

Design flush

Other Attributes

Weight 0,065 kg

Operating-/Indication part

Switching angle 42° right

IP-Rating

Front protection IP65

Actuator

Switching action Rest(a) - Momentary

Switching element

Rotary positions 2

Function

Keylock switch

EAO – Your Expert Partner for Human Machine Interfaces

61-2101.0/D - Keylock switch actuator 2 positions square

Dimensions

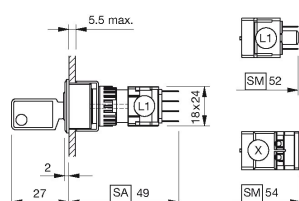

L1 = Solder/Plug-in terminal 2.8 x 0.5 mm

Mounting cut-outs

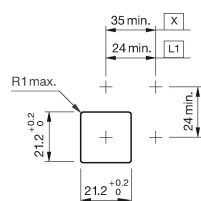

L1 = Solder/Plug-in terminal 2.8 x 0.5 mm

Wiring diagram



Switching positions

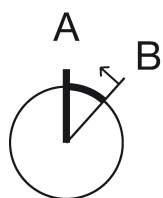

Additional information

Standard lock: DOM 311

Two keys are supplied with each key lock switch

Optional lock numbers on request

Legend

Switching action: A = Rest, B = Momentary