

EAO – Your Expert Partner for Human Machine Interfaces

704.078.0 - Stop switch actuator

704.078.0 - Stop switch actuator

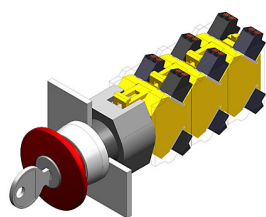

Attention: The preview is based on a sample product. This can differ from your current configuration.

Mounting

Mounting cut-out	Ø 22,3 mm
Design	raised

Front

Front ring material	Aluminium
Front shape	round
Front dimension	Ø 40 mm
Front ring colour	natural anodized

Other Attributes

Weight	0,063 kg
--------	----------

Operating-/Indication part

Lens material	Plastic
Lens optics	opaque
Lens profile	Mushroom
Lens colour	red
Lens illumination	non-illuminative

IP-Rating

Front protection	IP65
------------------	------

Actuator

Switching action	Maintained
------------------	------------

Function

Stop switch

EAO – Your Expert Partner for Human Machine Interfaces

704.078.0 - Stop switch actuator

Dimensions

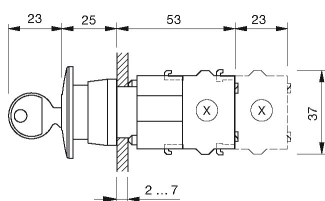

X = Screw terminal

Mounting cut-outs

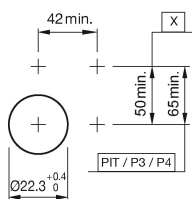

PIT = Push-in terminal

Wiring diagram

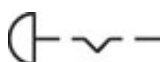

Additional information

Key to unlock clockwise

Locknumbers 251, lock type Ronis

Two keys are supplied with each key lock switch

Further lock numbers see «Technical data»

Max. 3 switching elements can be clipped on

The colour of anodized aluminium parts can vary due to technical production reasons

Legend

Switching action: C = Maintained