

EAO – Your Expert Partner for Human Machine Interfaces

14-517.0360 - Selector switch actuator 2 positions

14-517.0360 - Selector switch actuator 2 positions

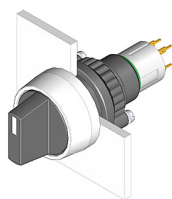

Attention: The preview is based on a sample product. This can differ from your current configuration.

Mounting

Mounting cut-out	Ø 22,3 mm
Design	raised

Front

Front dimension	Ø 29 mm
Front shape	round
Front bezel colour	natural anodized
Front bezel material	Aluminium

Other Attributes

Weight	0,025 kg
--------	----------

Operating-/Indication part

Lever illumination	non-illuminative
Lever colour	black
Lever material	Plastic
Lever shape	short
Switching angle	42° right

IP-Rating

Front protection	IP67
------------------	------

Connection Method

Terminal	Universal 2.0 x 0.5 mm
----------	------------------------

Actuator

Switching action	Rest - Momentary
------------------	------------------

Switching element

Rotary positions	2
Switching system	Low-level element
Switching current	0.1 A
Switching voltage	42 V AC/DC
Contacts	1 NC + 1 NO
Contact material	gold-plated silver

Function

Selector switch

EAO – Your Expert Partner for Human Machine Interfaces

14-517.0360 - Selector switch actuator 2 positions

Dimensions

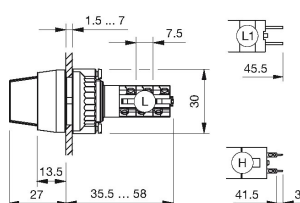

H = Universal terminal 2.0 x 0.5 mm

Mounting cut-outs

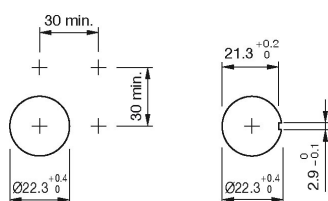

Wiring diagram



Component layout

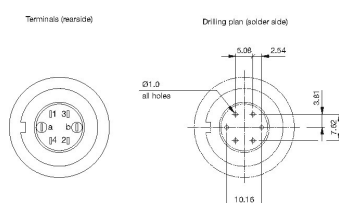

Additional information

The colour of anodized aluminium parts can vary due to technical production reasons

Legend

Contacts: NC = Normally closed, NO = Normally open
Switching action: A = Rest, B = Momentary

EAO – Your Expert Partner for **Human Machine Interfaces**

14-517.0360 - Selector switch actuator 2 positions

Switching positions

