

EAO – Your Expert Partner for Human Machine Interfaces

704.118.0 - Keylock switch actuator 3 positions

704.118.0 - Keylock switch actuator 3 positions

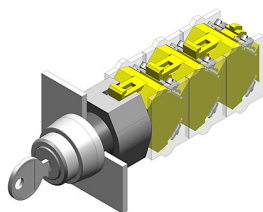

Attention: The preview is based on a sample product. This can differ from your current configuration.

Mounting

Mounting cut-out	Ø 22,3 mm
Design	raised

Front

Front shape	round
Front dimension	Ø 29 mm
Front bezel colour	natural
Front bezel material	Aluminium

Other Attributes

Weight	0,070 kg
--------	----------

Operating-/Indication part

Switching angle

IP-Rating

Front protection	IP65
------------------	------

Actuator

Switching action	Momentary - Rest(a) - Maintain
------------------	--------------------------------

Switching element

Rotary positions	3
max. number of switching elements	3

Function

Keylock switch

EAO – Your Expert Partner for Human Machine Interfaces

704.118.0 - Keylock switch actuator 3 positions

Dimensions

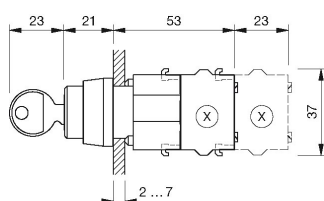

X = Screw terminal

Mounting cut-outs

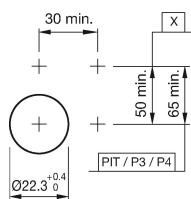

PIT = Push-in terminal

Wiring diagram



Switching positions

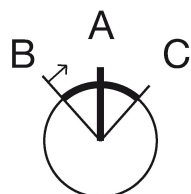

Additional information

Locknumbers 251, lock type Ronis

Two keys are supplied with each key lock switch

Further lock numbers see «Technical data»

Max. 3 switching elements can be clipped on

Legend

Switching action: A = Rest, B = Momentary, C = Maintained