

EAO – Your Expert Partner for Human Machine Interfaces

704.343.0 - Keylock switch actuator 2 positions

704.343.0 - Keylock switch actuator 2 positions

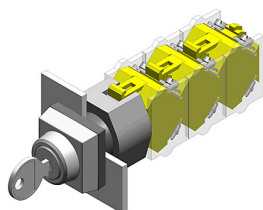

Attention: The preview is based on a sample product. This can differ from your current configuration.

Mounting

Mounting cut-out	Ø 22,3 mm
Design	raised

Front

Front dimension	30 x 30 mm
Front shape	square
Front bezel material	Plastic
Front bezel colour	grey

Other Attributes

Weight	0,070 kg
--------	----------

Operating-/Indication part

Switching angle	42° right
-----------------	-----------

IP-Rating

Front protection	IP65
------------------	------

Actuator

Switching action	Rest(a) - Momentary
------------------	---------------------

Switching element

Rotary positions	2
max. number of switching elements	3

Function

Keylock switch

EAO – Your Expert Partner for Human Machine Interfaces

704.343.0 - Keylock switch actuator 2 positions

Dimensions

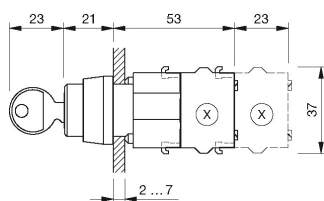

X = Screw terminal

Mounting cut-outs

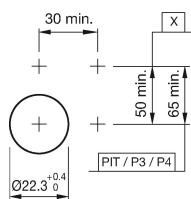

PIT = Push-in terminal

Wiring diagram

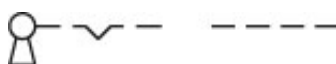

Switching positions

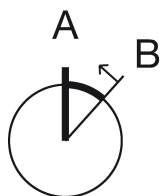

Additional information

Locknumbers 251, lock type Ronis

Two keys are supplied with each key lock switch

Further lock numbers see «Technical data»

Max. 3 switching elements can be clipped on

Legend

Switching action: A = Rest, B = Momentary